



GUIDANCE METHODE	MANUAL
PROCESS TYPE	TIG
COOLING TYPE	GAS
TUNGSTEN DIAMETER	0.5 - 4.0 mm
GAS VOLUME	3 - 11 l/min
STRAIN COMPLIES WITH TO	UNE-EN 60974/1
TORCH LENGTH	4, 8 m
ELECTRICAL CONTROL ACTIVATION	MICROSWITCH 50 mA -24V
TEST ACCORDING TO RULES	EN 60974-7

RATING	DC	AC
RATING 100%	202A	173A
RATING 60%	260A	224A



EN 60974-7

ERGODANI®

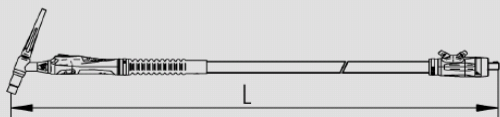
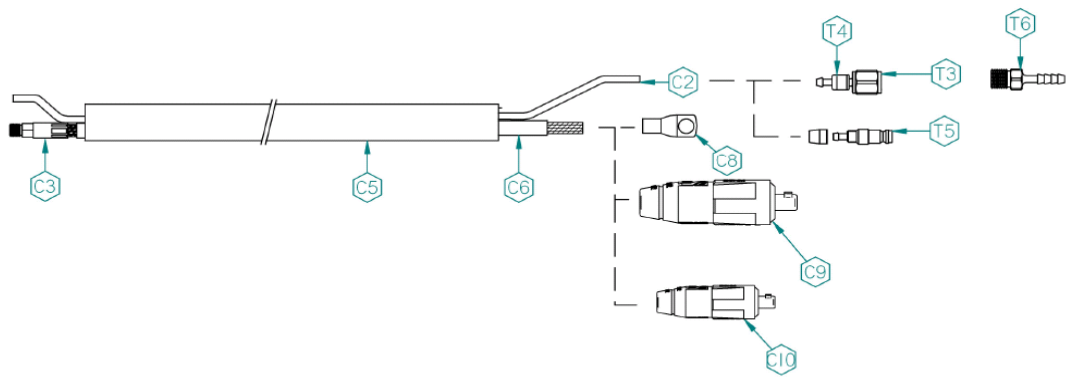
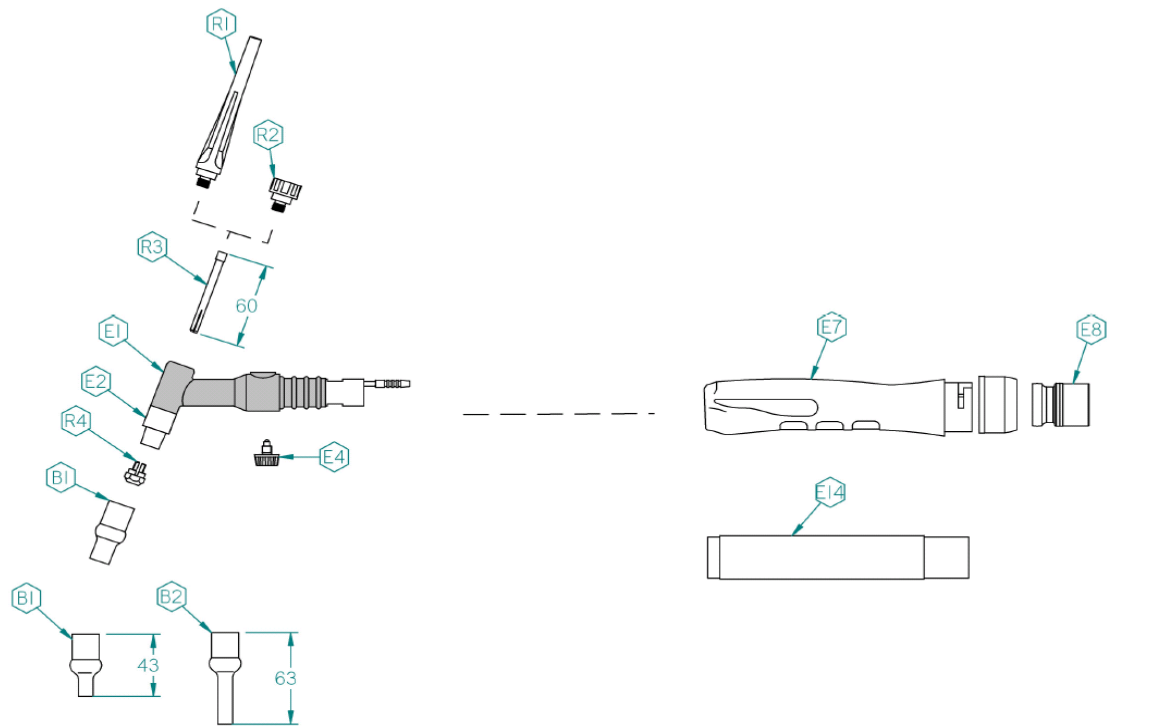

L: 4, 8 mts

226V

CATEC	POS.	CODE	DESCRIPTION		PACK
71		251220104_Z	BITUBE TORCH	226V LITTLE TIG 4 MTRS	1
71		251220108_Z	BITUBE TORCH	226V LITTLE TIG 7,5 MTRS	1
71	R-1	221TPLG1_Z	BACK CAP LONG	226V -411-70-	5
71	R-2	221TPCT1_Z	BACK CAP SHORT	226V -411-30-	5
71	R-3	221PZ10_Z	COLLET Ø 1'0MM.	210V -964-01- .040"	5
71	R-3	221PZ16_Z	COLLET Ø 1'6MM.	210V -965-01- 1/16"	5
71	R-3	299PZ20_Z	COLLET Ø 2'0MM.	SR-17-V/18W/26-V -10N26-	5
71	R-3	299PZ24_Z	COLLET Ø 2'4MM.	SR-17-V/18W/26-V -10N24- 3/32"	5
71	R-3	221PZ32_Z	COLLET Ø 3'2MM.	210V -967-01- 1/8"	5
71	R-3	221PZ40_Z	COLLET Ø 4'0MM.	210V -968-01- 5/32"	5
71	E-1	222VA01_Z	TORCH BODY VALVE	226V -226V-00-	1
71	E-2	22102_Z	INSULATOR	210V	5
71	E-4	226V_Z	VALVE CAP	SR-18V/26V/226V -VS1-	5
71	E-7	22699011_Z	BLACK HANDLE VALVE	SR26V/18WV P-5015 LITTLE TIG	1
71	E-8	2000106V_Z	SET JOINT+COLLET	LITTLE TIG	1
71	E-14	2269901_Z	CILINDRIC HANDLE	SR-18W/26 -H200-	1
71	R-4	221GU10_Z	GUIDE Ø 1'0MM.	210V -961-41- .040"	5
71	R-4	221GU16_Z	GUIDE Ø 1'6MM.	210V -961-51- 1/16"	5
71	R-4	221GU24_Z	GUIDE Ø 2'4MM.	210V -961-61- 3/32"	5
71	R-4	221GU32_Z	GUIDE Ø 3'2MM.	210V -961-71- 1/8"	5
71	R-4	221GU40_Z	GUIDE Ø 4'0MM.	210V -961-81- 5/32"	5
71	B-1	22130_Z	CERAMIC CUP	210V -130-00- #4 1/4"	10
71	B-1	22130O_Z	CERAMIC CUP	210V -130-00- #4 1/4" OR/TC	10
71	B-1	22131_Z	CERAMIC CUP	210V -131-00- #5 5/16"	10
71	B-1	22131O_Z	CERAMIC CUP	210V -131-00- #5 5/16"OR/TC	10
71	B-1	22132_Z	CERAMIC CUP	210V -132-00- #6 3/8"	10
71	B-1	22132O_Z	CERAMIC CUP	210V -132-00- #6 3/8" OR/TC	10
71	B-1	22133_Z	CERAMIC CUP	210V -133-00- #7 7/16"	10
71	B-1	22133O_Z	CERAMIC CUP	210V -133-00- #7 7/16"OR/TC	10
71	B-1	22134_Z	CERAMIC CUP	210V -134-00- #8 1/2"	10
71	B-1	22134O_Z	CERAMIC CUP	210V -134-00- #8 1/2" OR/TC	10
71	B-1	22135_Z	CERAMIC CUP	210V -135-00- #9 9/16"	10
71	B-1	22135O_Z	CERAMIC CUP	210V -135-00- #9 9/16"OR/TC	10
71	B-1	22136_Z	CERAMIC CUP	210V -136-00- #10 1/4"	10
71	B-1	22136O_Z	CERAMIC CUP	210V -136-00- #10 1/4"OR/TC	10
71	B-2	2213007_Z	CERAMIC CUP LONG	210V -130-07- #4 1/4"	10
71	B-2	2213107_Z	CERAMIC CUP LONG	210V -131-07- #5 5/16"	10
71	B-2	2213207_Z	CERAMIC CUP LONG	210V -132-07- #6 3/8"	10
71	B-2	2213307_Z	CERAMIC CUP LONG	210V -133-07- #7 7/16"	10
71	B-2	2213407_Z	CERAMIC CUP LONG	210V -134-07- #8 1/2"	10
71	B-2	2213507_Z	CERAMIC CUP LONG	210V -135-07- #9 9/16"	10
71	C-2	299TG36_Z	CABLE PVC BLACK FOR MTRS.	Ø3*6MM.	100
71	C-2	299TG36B_Z	CABLE PVC WHITE FOR MTRS.	Ø3*6MM.	100
71	C-3	222CAD_Z	PLUG CABLE FRONT	226V -CTC-226-	5
71	C-5	08F2225_Z	LINING EXTERIOR	IMPACT SR-26V/SR-18WV	40
71	C-8	221CAT1_Z	PLUG CABLE REAR	210V Ø 35/12MM.	5
71	C-9	4AM3550_Z	CABLE PLUG	35/50.	10
71	C-10	4AM1025_Z	CABLE PLUG	10/25.	25
71	T-3	299TG2_Z	REAR NUT GAS TIG NICKEL	1/4GAS	10
71	T-4	299TG88_Z	REAR NIPPLE GAS TIG	Ø3*6MM.	10
71	T-5	145TA88A_Z	PLUG FOR CENTRAL CONNECTOR	EM-401W/501W	10
71	T-6	221PG_Z	EXTENDER TUBE GAS	210V/226V	10