



optional:
LEVER SWITCH

GUIDANCE METHODE	MANUAL
PROCESS TYPE	TIG
COOLING TYPE	GAS
TUNGSTEN DIAMETER	0,5 - 4,0 mm
GAS VOLUME	3 - 11 l/min
STRAIN COMPLIES WITH TO UNE-EN 60974/1	113V CC
TORCH LENGTH	4, 8 m
ELECTRICAL CONTROL ACTIVATION	MICROSWITCH 50 mA -24V
TEST ACCORDING TO RULES	EN 60974-7

RATING	DC	AC
RATING 100%	202A	173A
RATING 60%	260A	224A



EN 60974-7

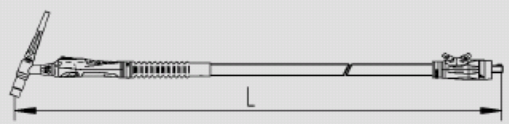
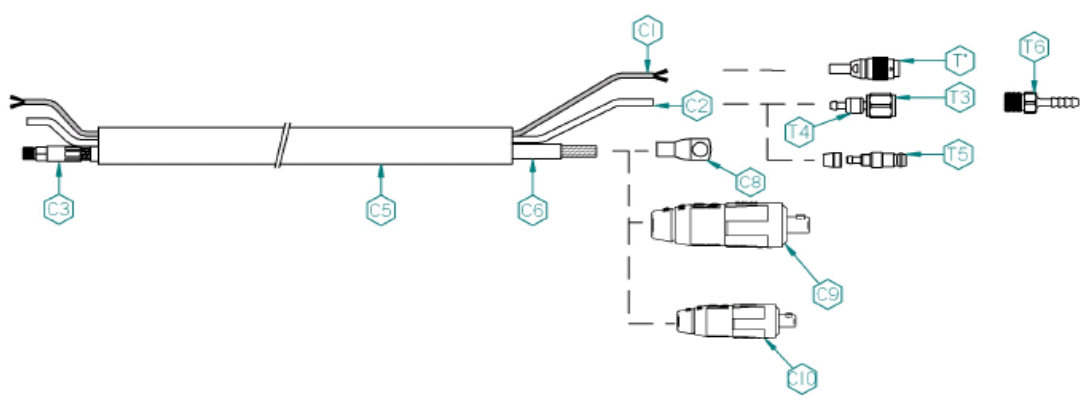
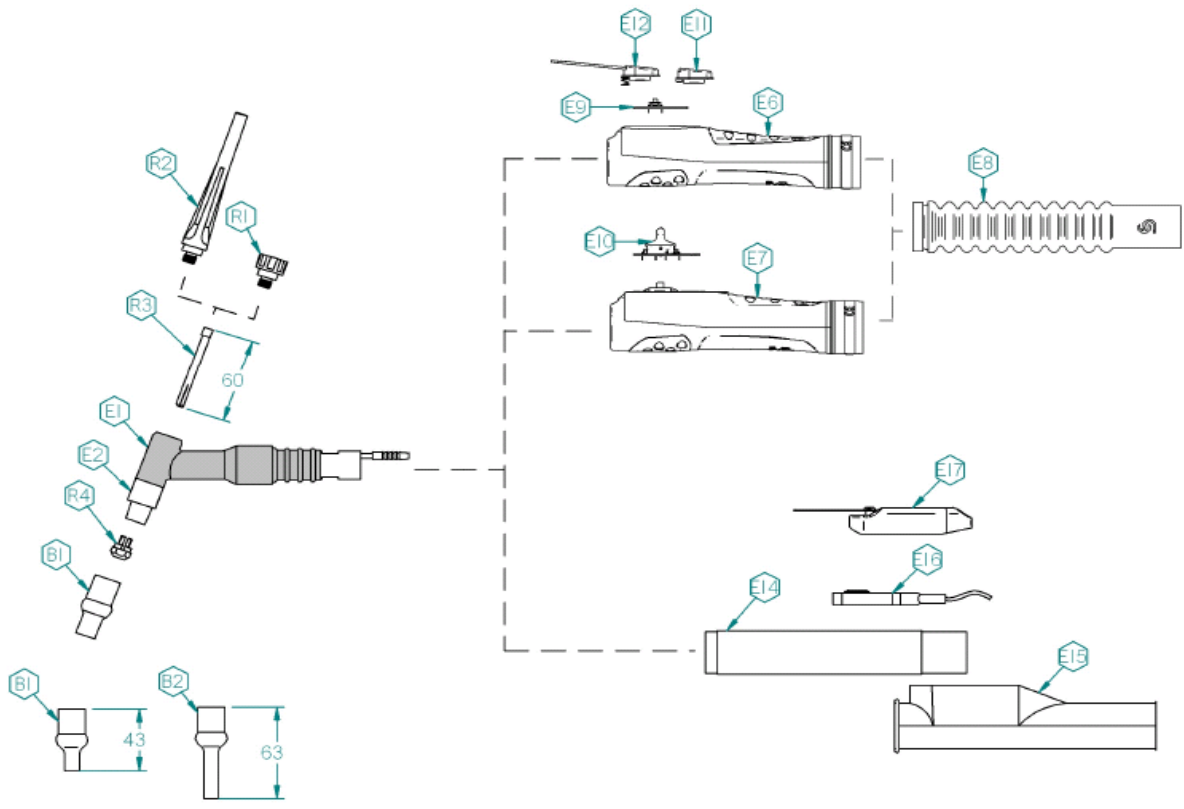

L: 4, 8 mts

CATEC	POS.	CODE	DESCRIPTION		PACK
64		252220104_S	BITUBE TORCH	226 LITTLE TIG 4 MTRS	1
64		252220108_S	BITUBE TORCH	226 LITTLE TIG 7,5 MTRS.	1
64		253220104_S	BITUBE TORCH 4 SWITCHES	226 LITTLE TIG 4 MTRS	1
64		253220108_S	BITUBE TORCH 4 SWITCHES	226 LITTLE TIG 8 MTRS	1
64	R-1	221TPLG1_S	BACK CAP LONG	226V -411-70-	5
64	R-2	221TPCT1_S	BACK CAP SHORT	226V -411-30-	5
64	R-3	221PZ10_S	COLLET Ø 1'0MM.	210V -964-01- .040"	5
64	R-3	221PZ16_S	COLLET Ø 1'6MM.	210V -965-01- 1/16"	5
64	R-3	221PZ20_S	COLLET Ø 2'0MM.	210V	5
64	R-3	221PZ24_S	COLLET Ø 2'4MM.	210V -966-01- 3/32"	5
64	R-3	221PZ32_S	COLLET Ø 3'2MM.	210V -967-01- 1/8"	5
64	R-3	221PZ40_S	COLLET Ø 4'0MM.	210V -968-01- 5/32"	5
64	E-1	222EL01_S	TORCH BODY ELECTRIC	226 -226-00-	1
64	E-2	22102_S	INSULATOR	210V	5
64	E-6	20001012_S	HANDLE 1 TRIGGER	LITTLE TIG SR26/18W	1
64	E-7	20001015_S	HANDLE 4 TRIGGERS	LITTLE TIG SR26/18W	1
64	E-8	2000106_S	ELECTRICAL HANDEL MANTLE	LITTLE TIG	1
64	E-9	20001021_S	MICROSWITCH 1	LITTLE TIG	5
64	E-10	20001032_S	COMPLETE TRIGGER 4P	LITTLE TIG	1
64	E-11	20001031_S	1-SWITCH HANDLE SWITCH	LITTLE TIG	5
64	E-12	20001033_S	LEVER SWITCH	LITTLE TIG	1
64	E-14	2269901_S	CILINDRIC HANDLE	SR-18W/26 -H200-	1
64	E-15	226EL02_S	FLAT MICRO LINER	SR-18W/26 -607853-BL1	1
64	E-16	29902_S	MICROSWITCH FLAT TIG	-SW1F-	5
64	E-17	299022_S	LEVER SWITCH TIG	-SW4-25-	1
64	R-4	221GU10_S	GUIDE Ø 1'0MM.	210V -961-41- .040"	5
64	R-4	221GU16_S	GUIDE Ø 1'6MM.	210V -961-51- 1/16"	5
64	R-4	221GU24_S	GUIDE Ø 2'4MM.	210V -961-61- 3/32"	5
64	R-4	221GU32_S	GUIDE Ø 3'2MM.	210V -961-71- 1/8"	5
64	R-4	221GU40_S	GUIDE Ø 4'0MM.	210V -961-81- 5/32"	5
64	B-1	22130_S	CERAMIC CUP	210V -130-00- #4 1/4"	10
64	B-1	22130O_S	CERAMIC CUP	210V -130-00- #4 1/4" OR/TC	10
64	B-1	22131_S	CERAMIC CUP	210V -131-00- #5 5/16"	10
64	B-1	22131O_S	CERAMIC CUP	210V -131-00- #5 5/16"OR/TC	10
64	B-1	22132_S	CERAMIC CUP	210V -132-00- #6 3/8"	10
64	B-1	22132O_S	CERAMIC CUP	210V -132-00- #6 3/8" OR/TC	10
64	B-1	22133_S	CERAMIC CUP	210V -133-00- #7 7/16"	10
64	B-1	22133O_S	CERAMIC CUP	210V -133-00- #7 7/16"OR/TC	10
64	B-1	22134_S	CERAMIC CUP	210V -134-00- #8 1/2"	10
64	B-1	22134O_S	CERAMIC CUP	210V -134-00- #8 1/2" OR/TC	10
64	B-1	22135_S	CERAMIC CUP	210V -135-00- #9 9/16"	10
64	B-1	22135O_S	CERAMIC CUP	210V -135-00- #9 9/16"OR/TC	10
64	B-1	22136_S	CERAMIC CUP	210V -136-00- #10 1/4"	10
64	B-1	22136O_S	CERAMIC CUP	210V -136-00- #10 1/4"OR/TC	10
64	B-2	2213007_S	CERAMIC CUP LONG	210V -130-07- #4 1/4"	10
64	B-2	2213107_S	CERAMIC CUP LONG	210V -131-07- #5 5/16"	10
64	B-2	2213207_S	CERAMIC CUP LONG	210V -132-07- #6 3/8"	10
64	B-2	2213307_S	CERAMIC CUP LONG	210V -133-07- #7 7/16"	10
64	B-2	2213407_S	CERAMIC CUP LONG	210V -134-07- #8 1/2"	10
64	B-2	2213507_S	CERAMIC CUP LONG	210V -135-07- #9 9/16"	10
64	C-1	0299CB_S	BIPOLAR CABLE Ø 0.75 MM	TIG	100
64	C-2	299TG36_S	CABLE PVC BLACK FOR MTRS.	Ø3*6MM.	100
64	C-2	299TG36B_S	CABLE PVC WHITE FOR MTRS.	Ø3*6MM.	100
64	C-3	222CAD_S	PLUG CABLE FRONT	226V -CTC-226-	5
64	C-5	08F2225_S	LINING EXTERIOR	IMPACT SR-26V/SR-18WV	40

64	C-8	221CAT_S	PLUG CABLE REAR	210V Ø 25/12MM.	5
64	C-9	4AM3550_S	CABLE PLUG	35/50.	10
64	C-10	4AM1025_S	CABLE PLUG	10/25.	25
64	T-3	299TG2_S	REAR NUT GAS TIG NICKEL	1/4GAS	10
64	T-4	299TG88_S	REAR NIPPLE GAS TIG	Ø3*6MM.	10
64	T-5	145TA88A_S	PLUG FOR CENTRAL CONNECTOR EM-401W/501W		10
64	T-6	221PG_S	EXTENDER TUBE GAS	210V/226V	10